

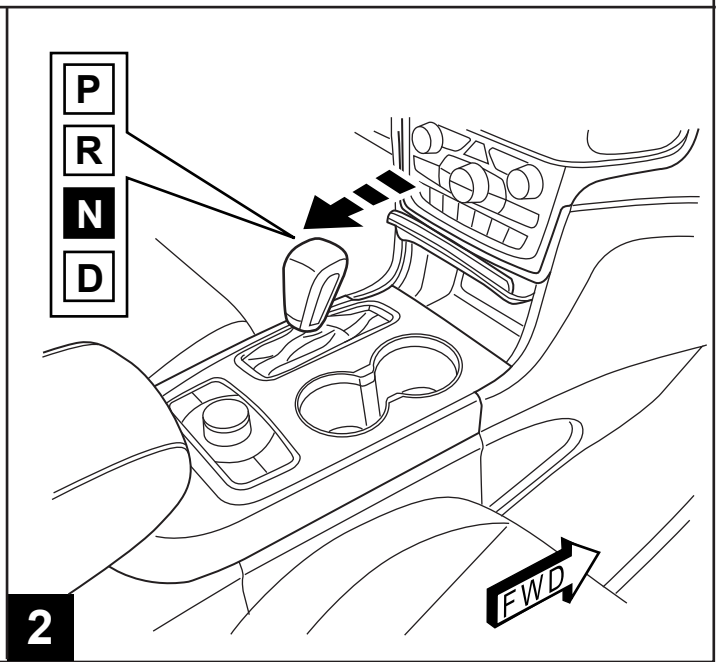

# FLAT TOW

## JEEP GRAND CHEROKEE / DODGE DURANGO

www.mopar.com

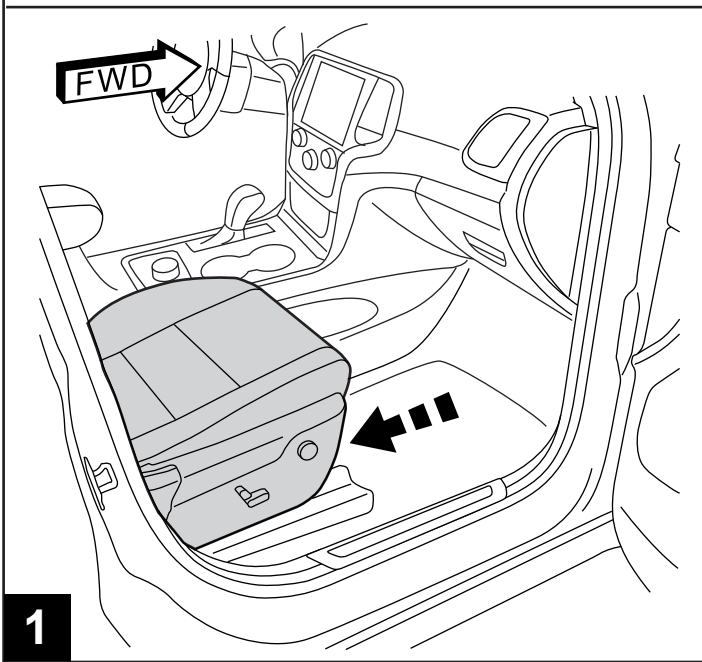
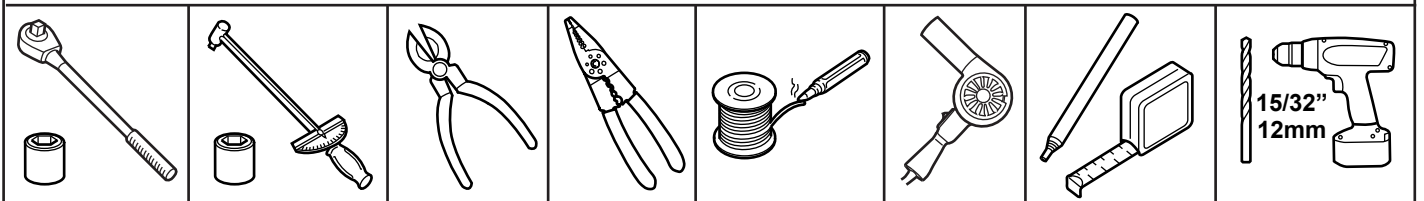
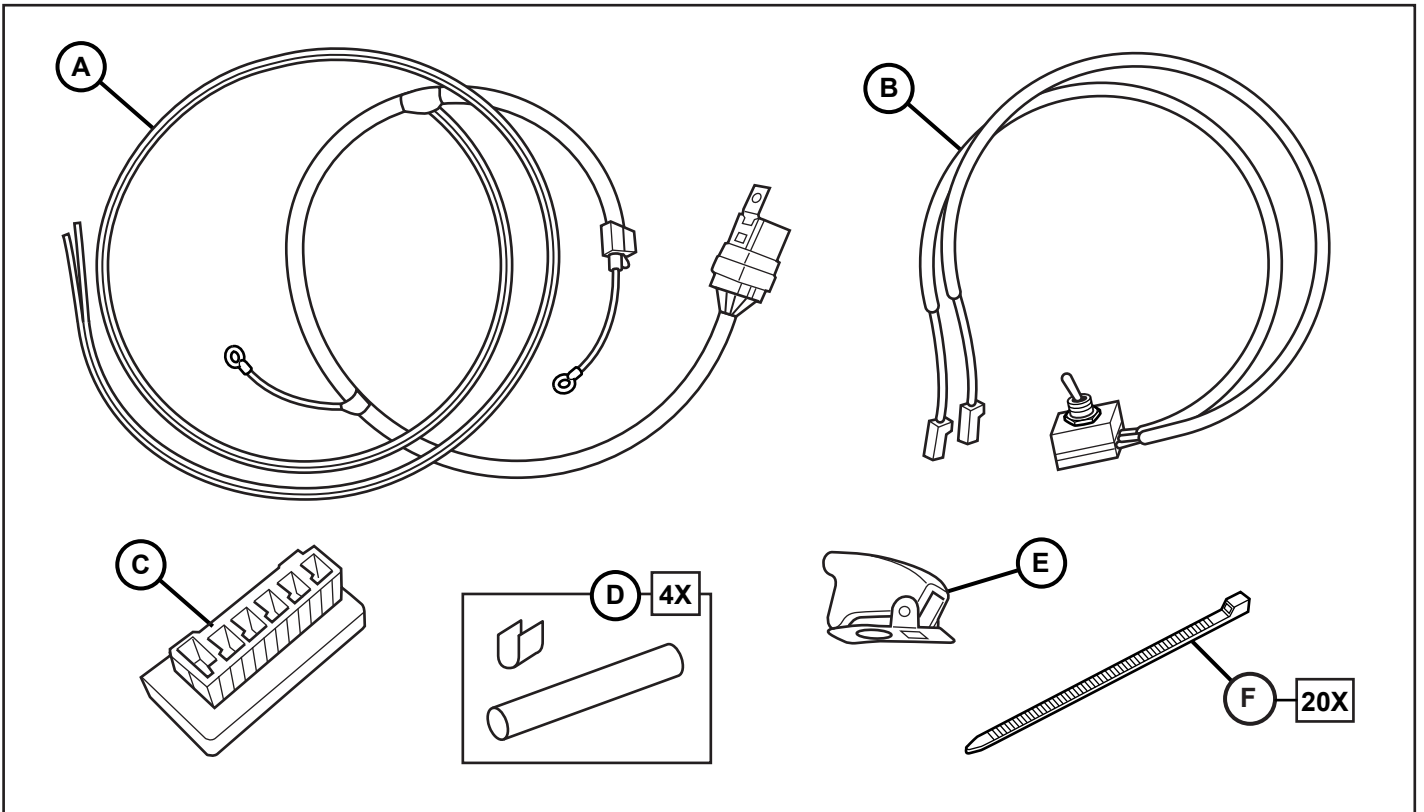

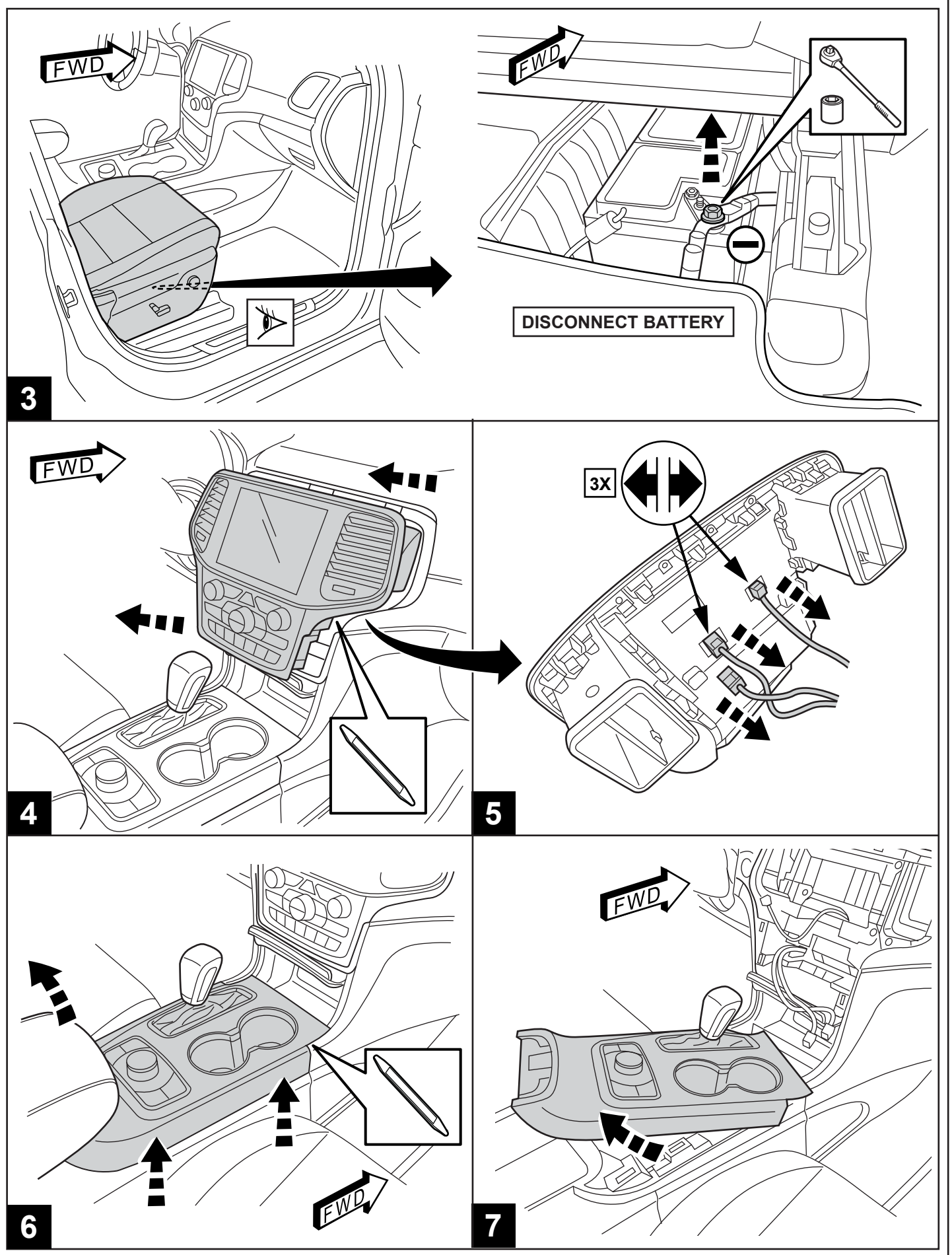

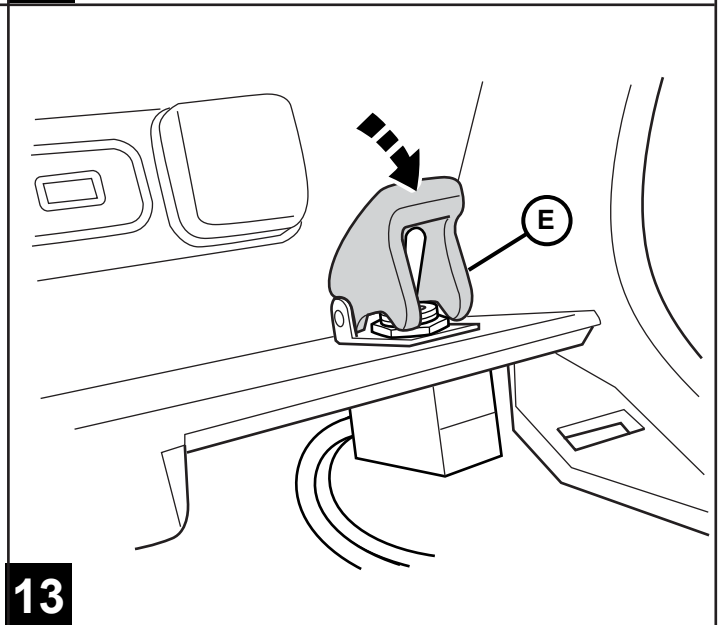
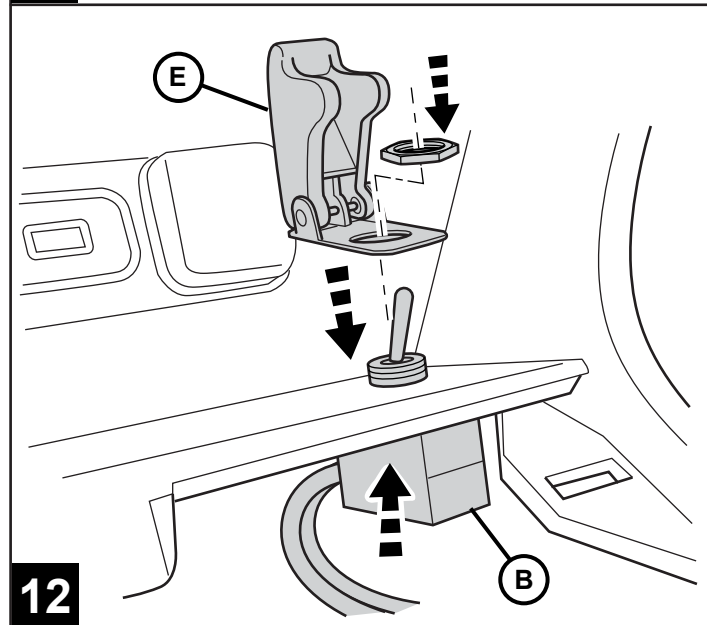
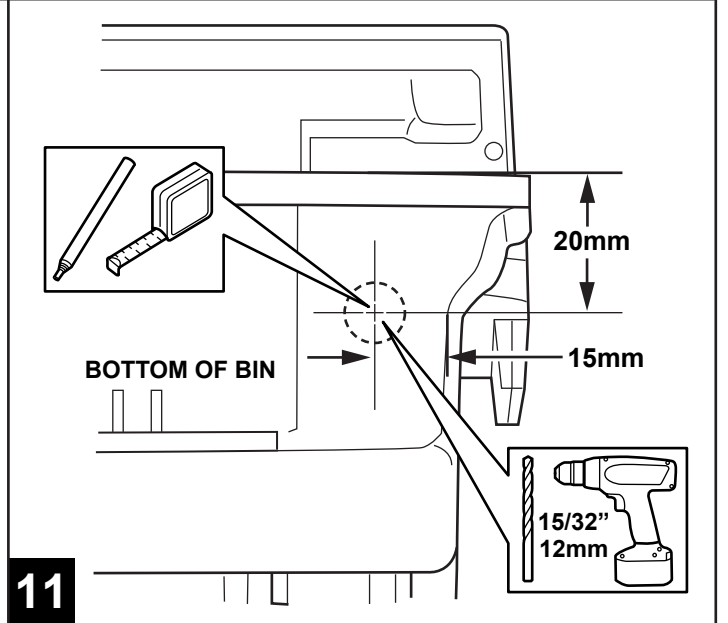
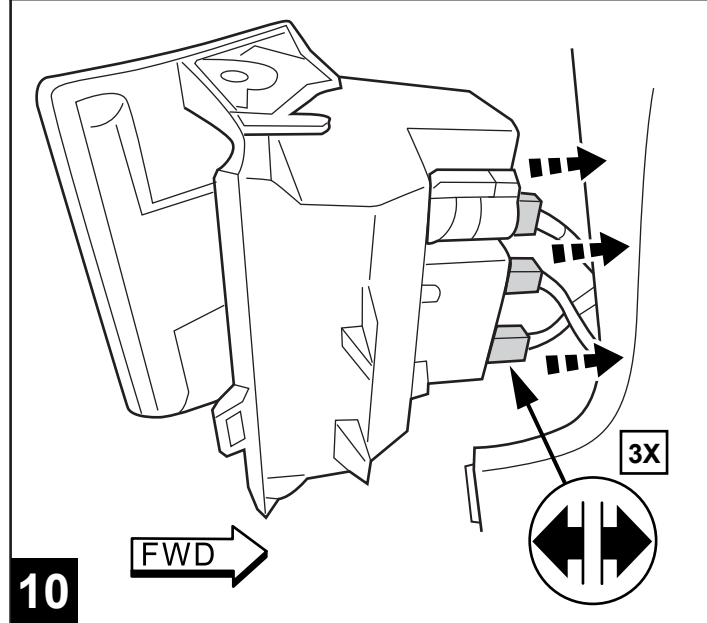
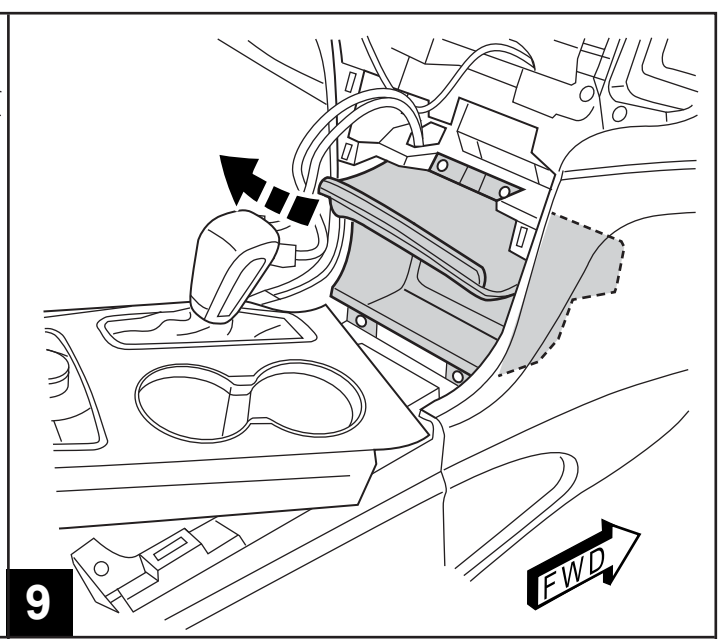
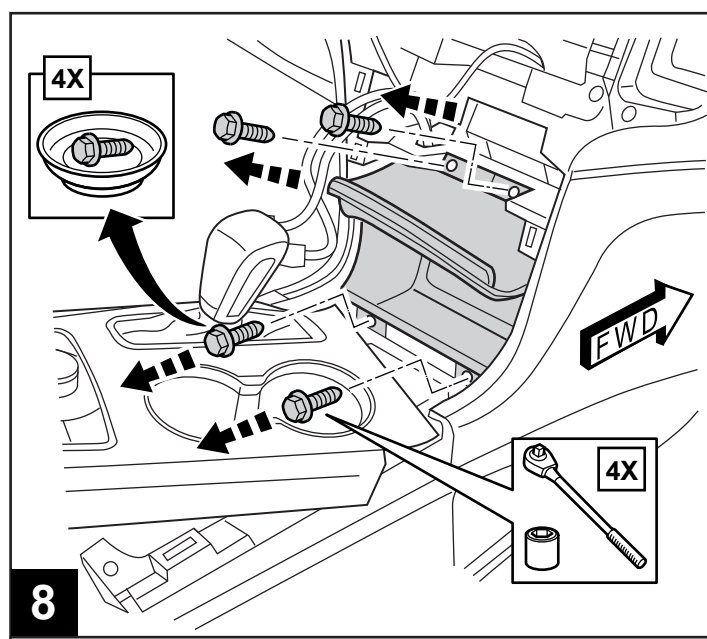

DODGE DURANGO  
STEPS 4 THROUGH 13  
WILL BE SIMILAR

NOTE DURANGO SWITCH LOCATION

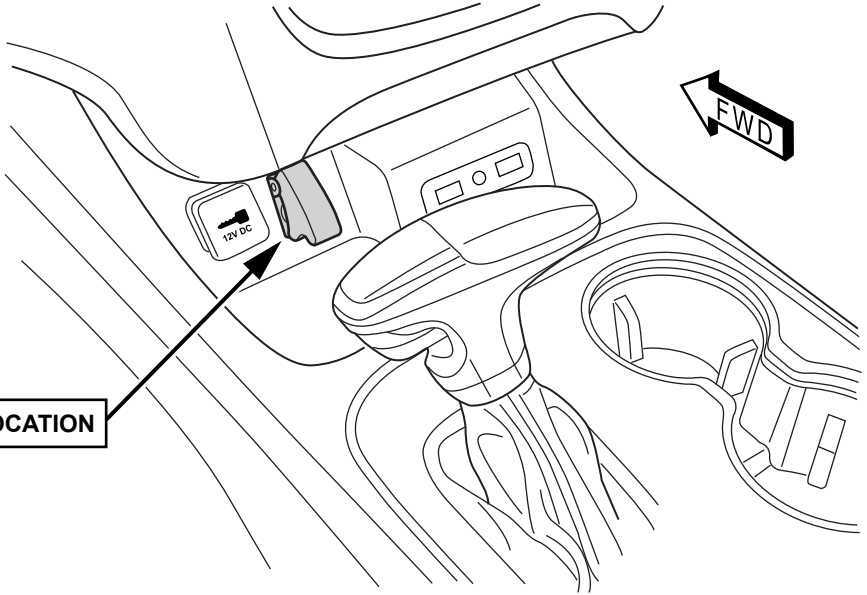

14

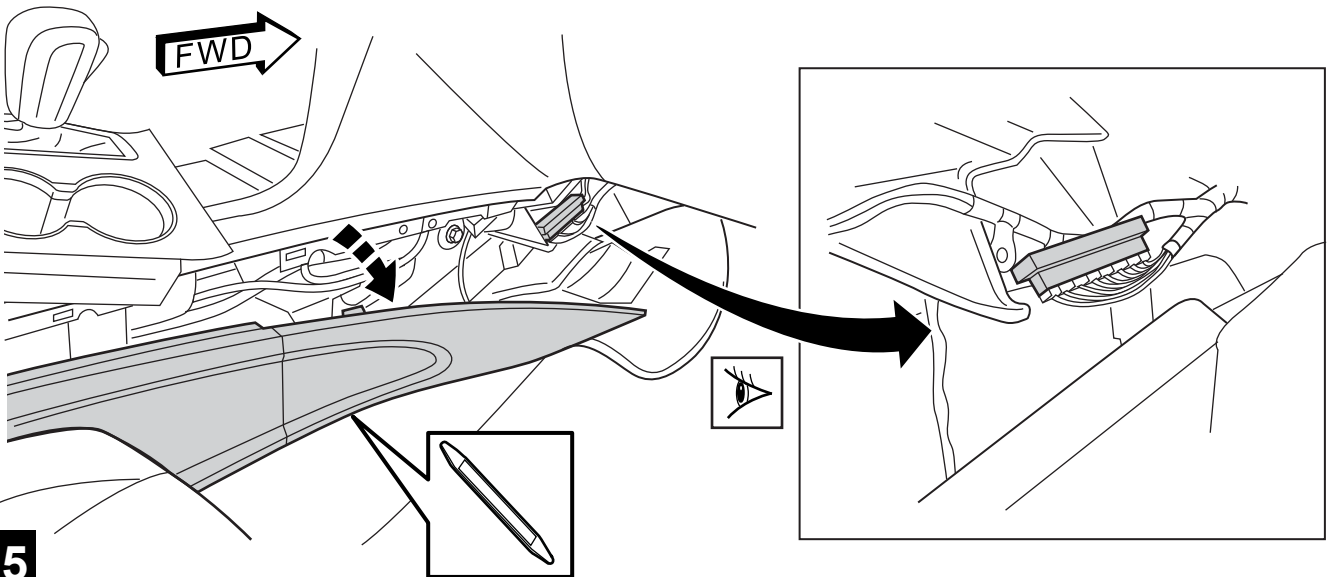

15

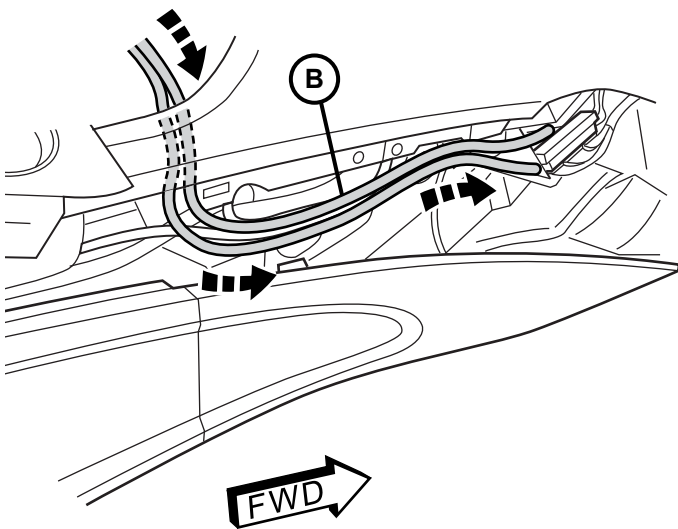

16

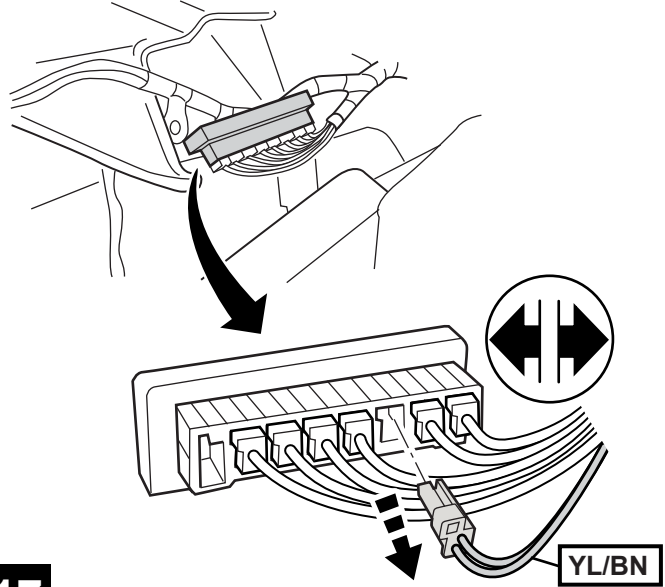

17



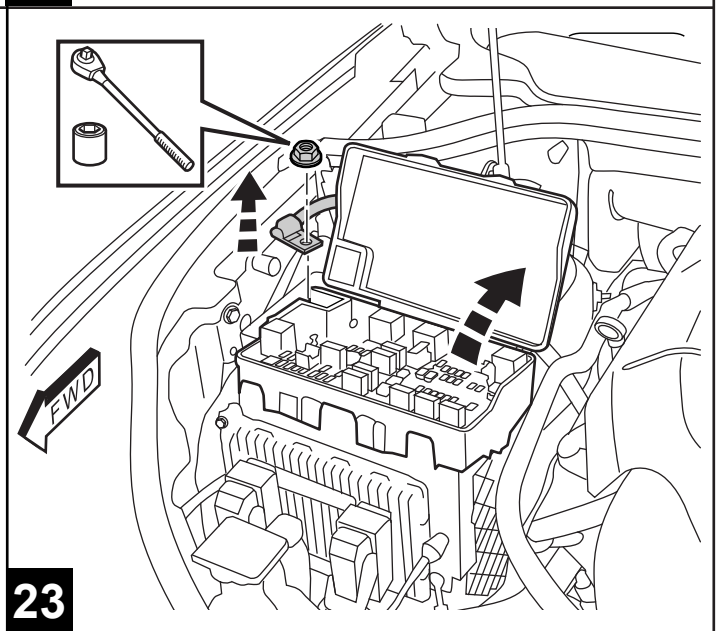
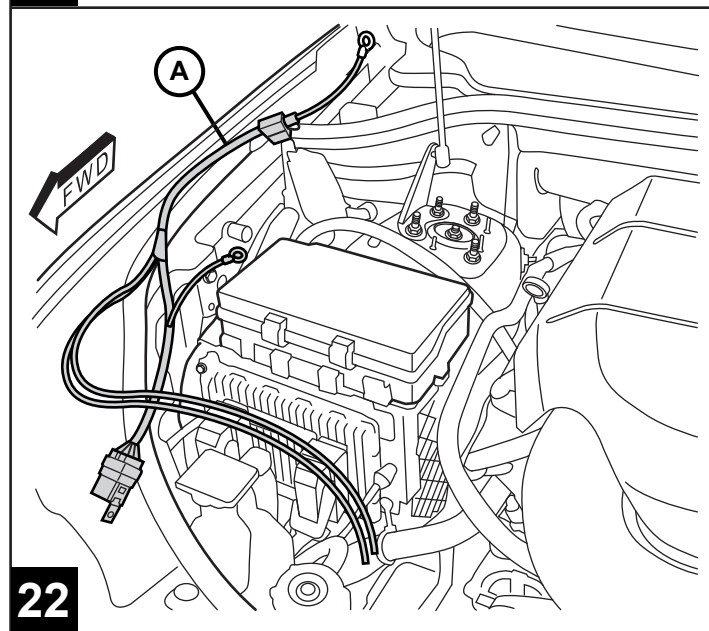
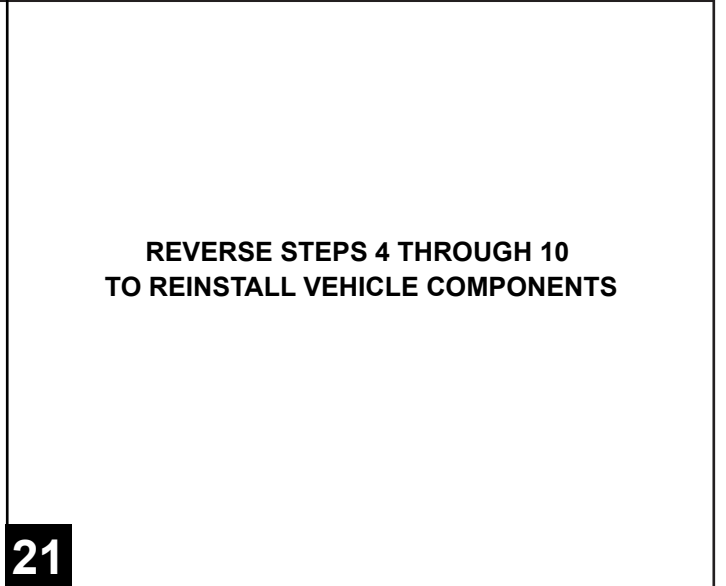
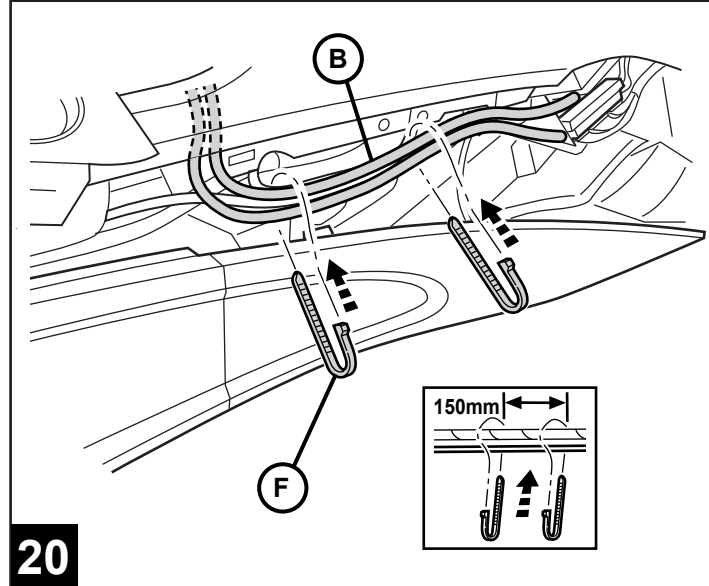
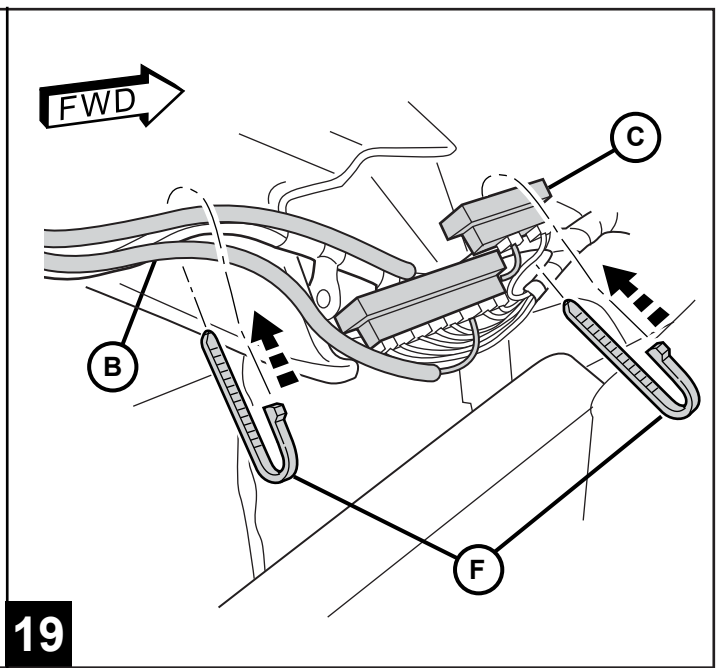
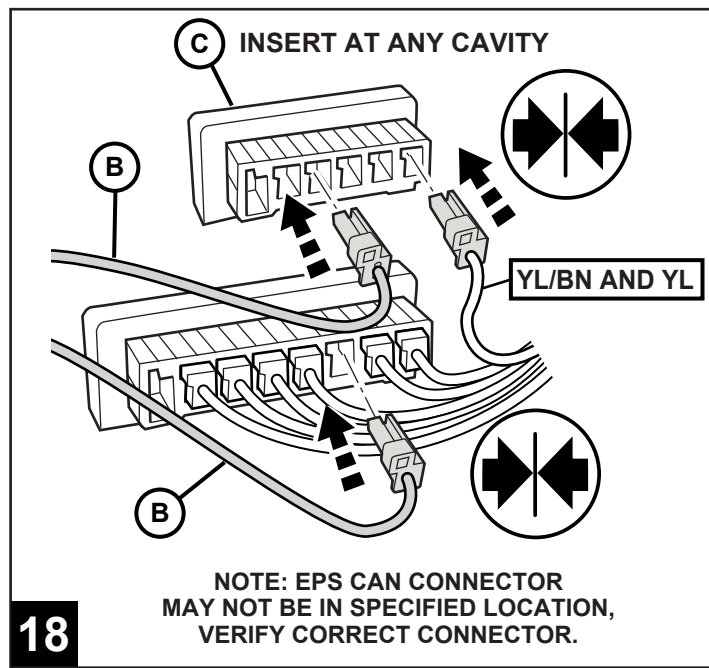

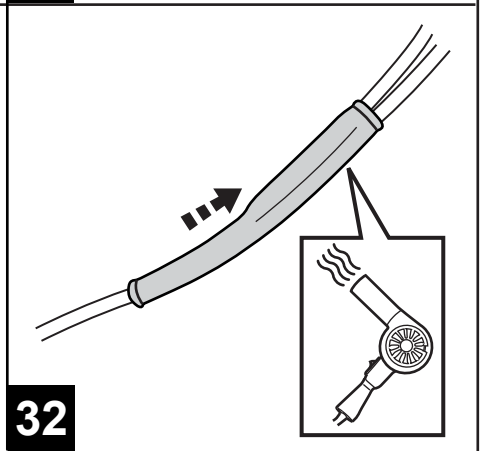
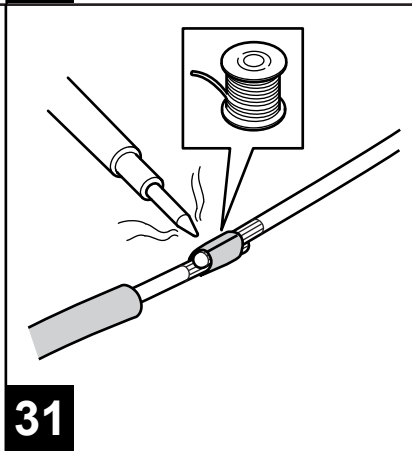
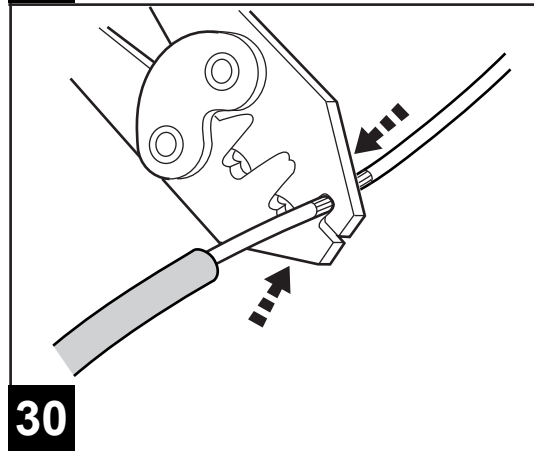
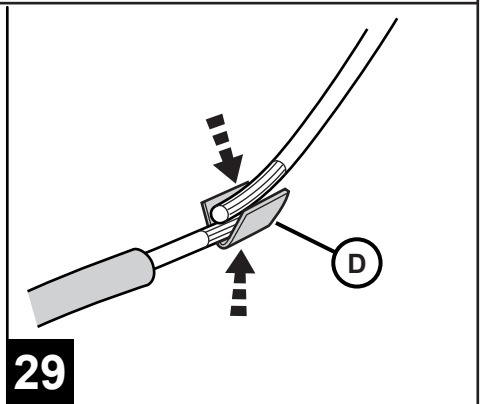
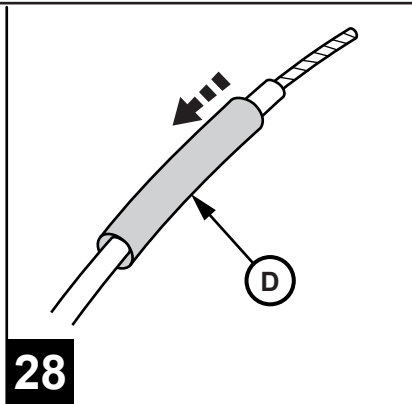
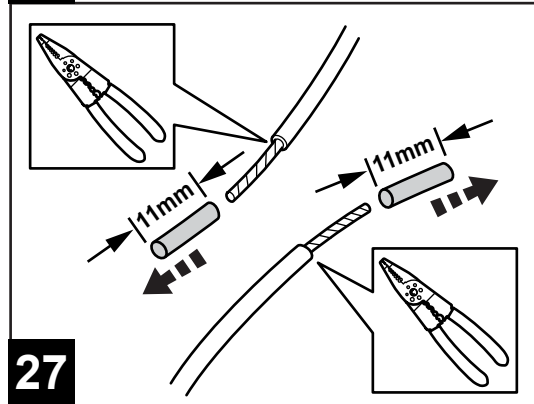
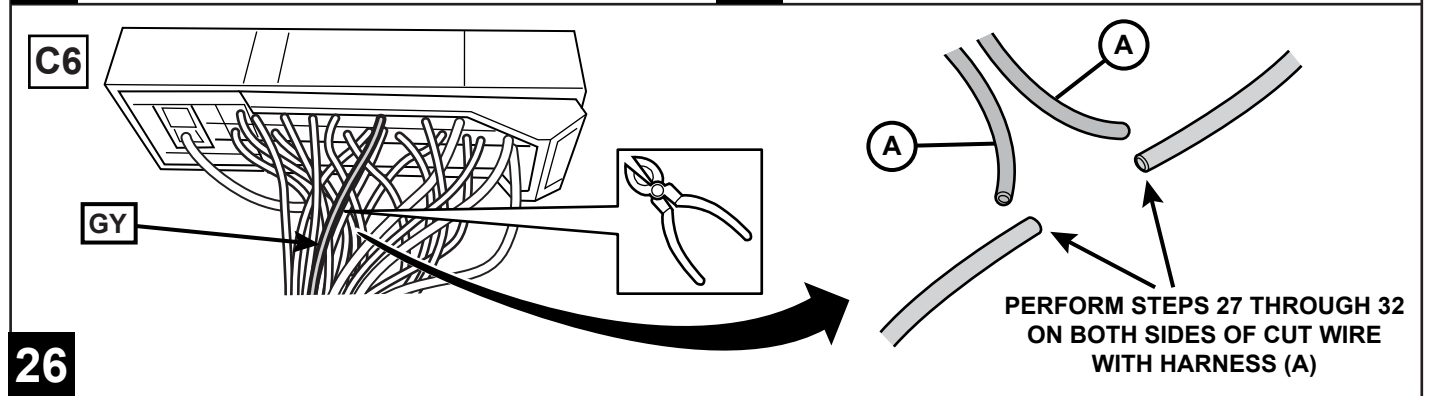
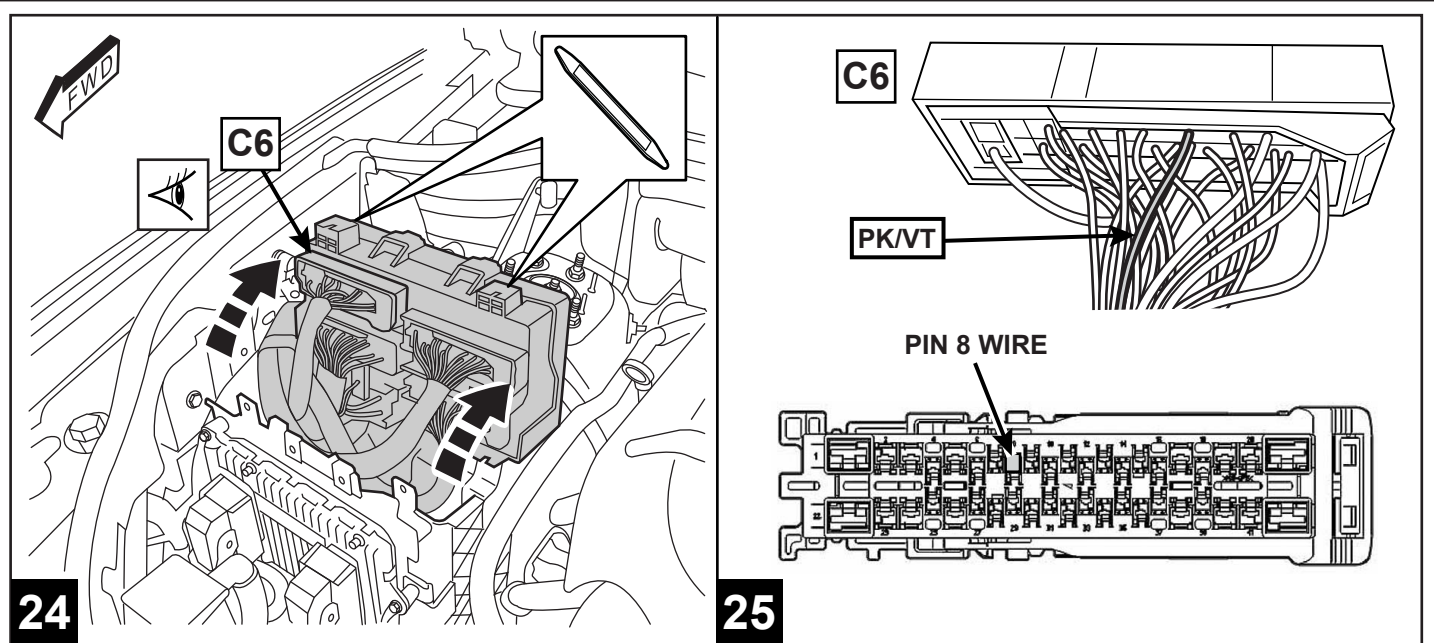

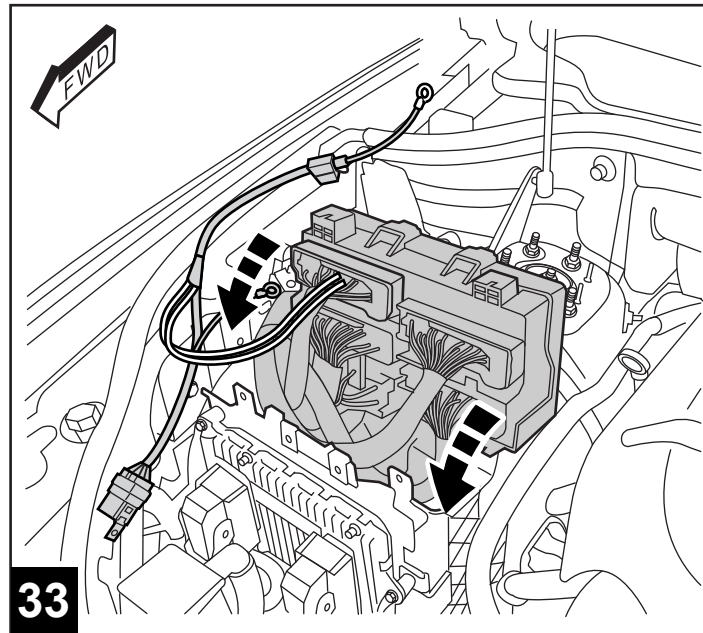

33

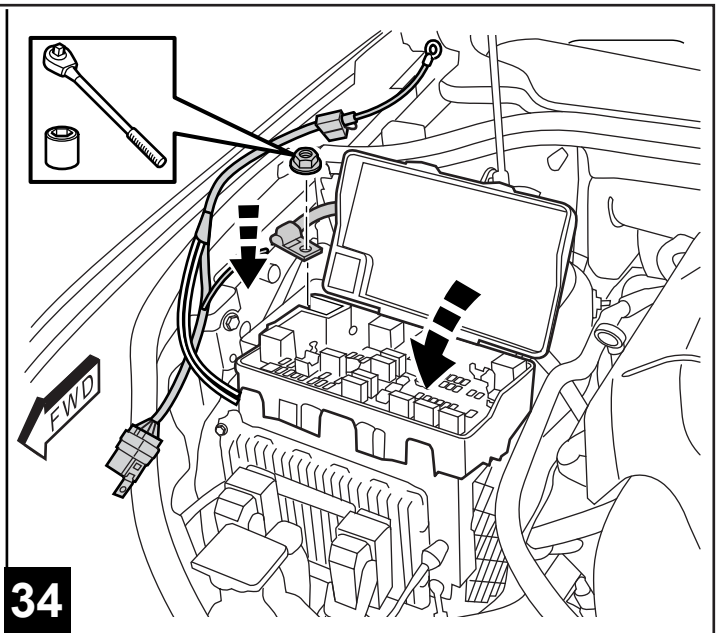

34

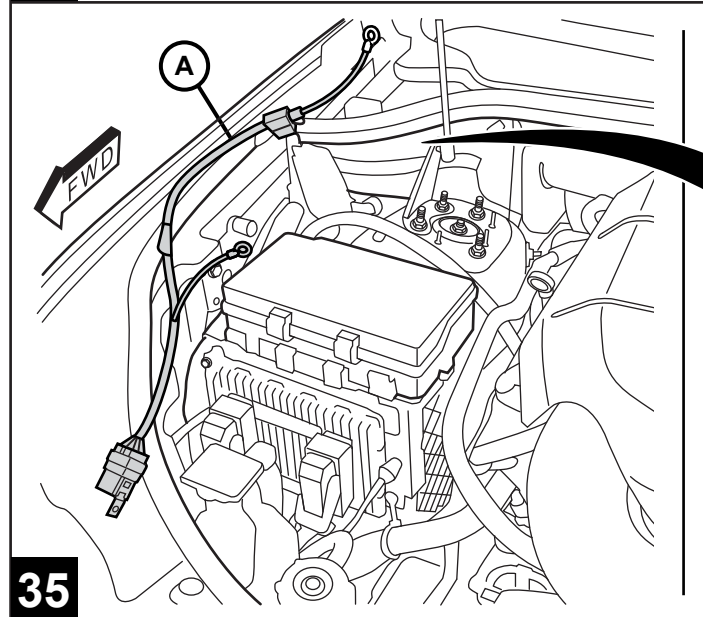

35

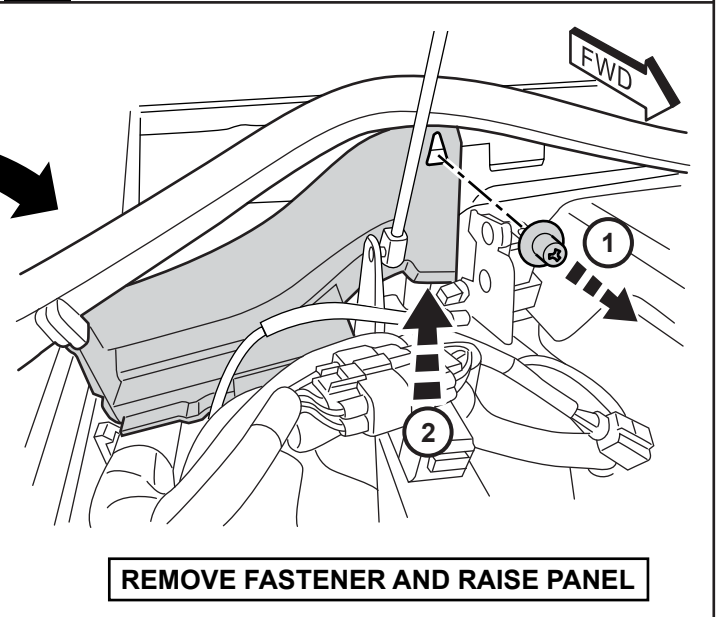

REMOVE FASTENER AND RAISE PANEL

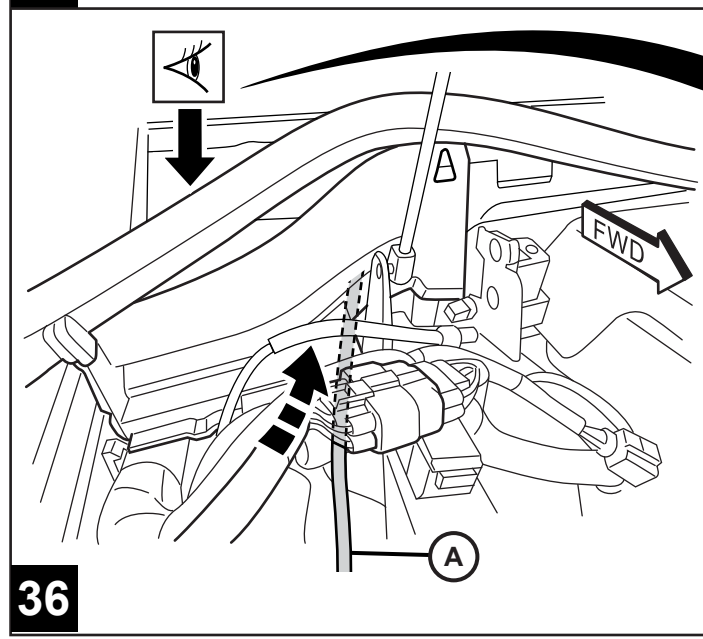

36

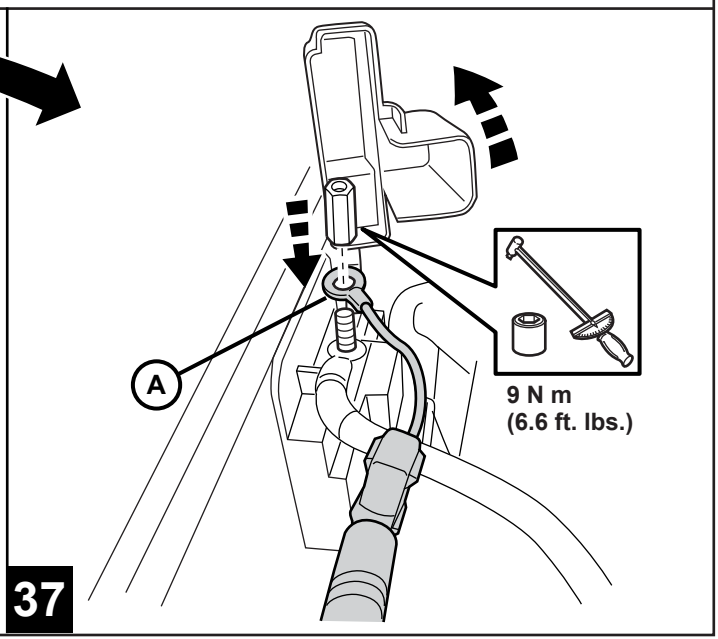

37



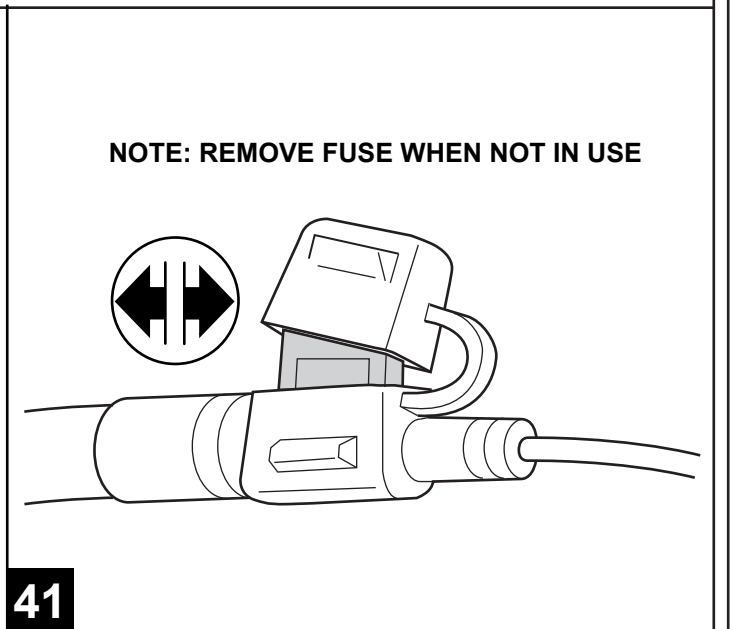
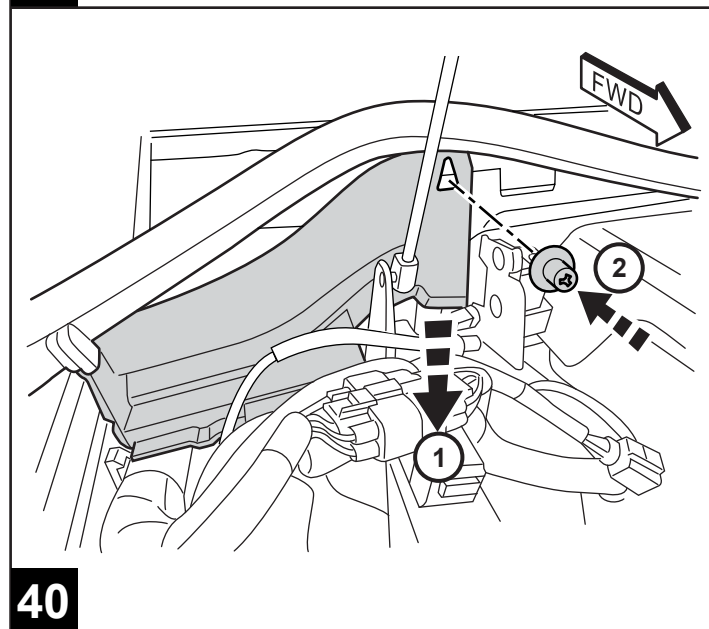
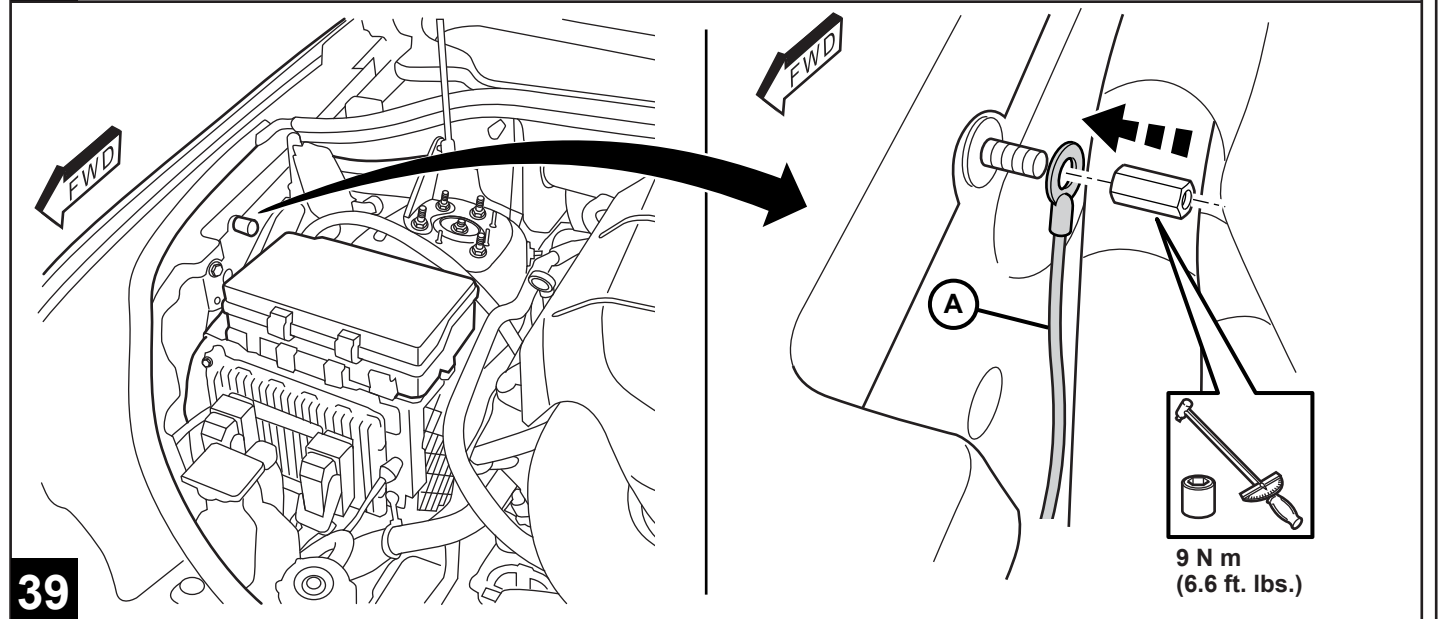
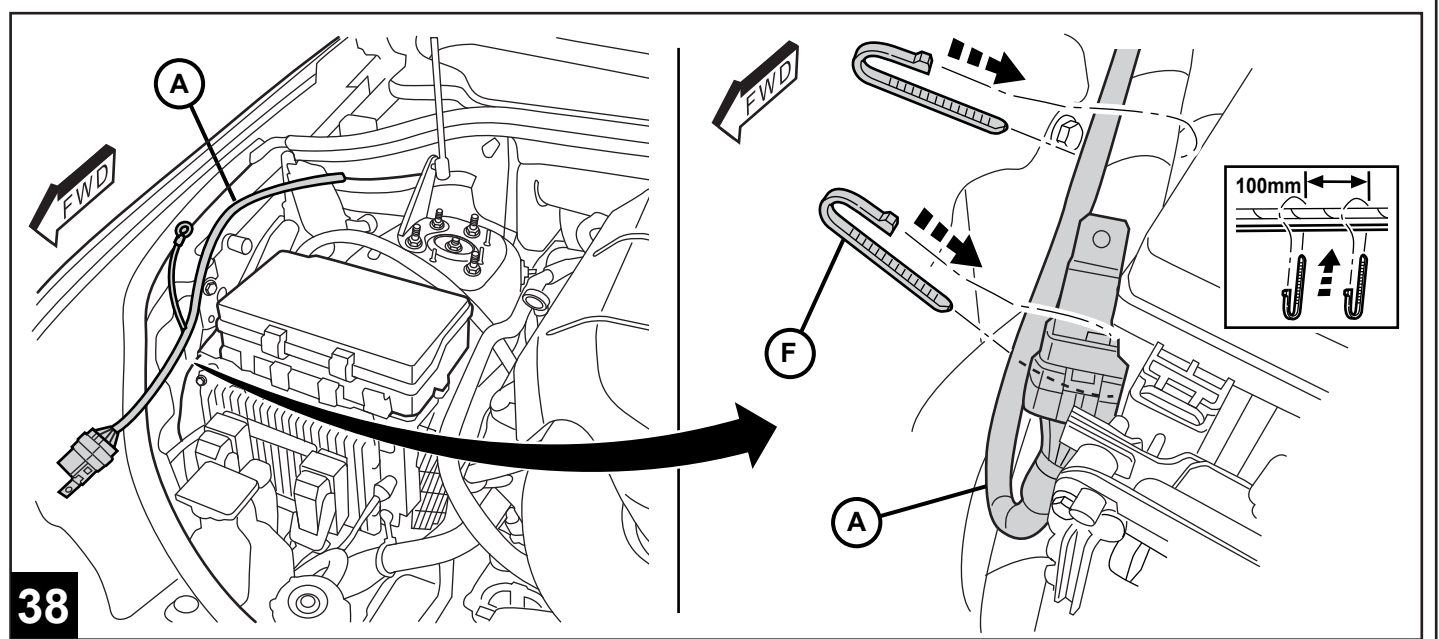



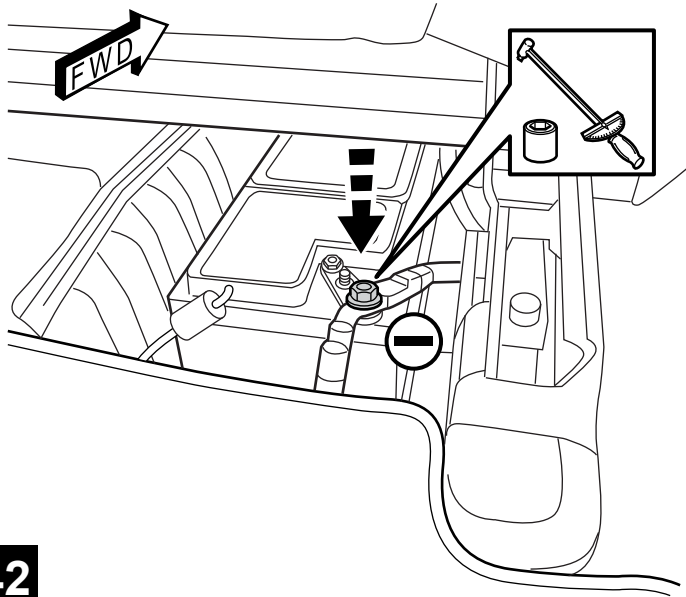

**CHECK ALL WIRING,  
TRIM EXCESS OFF CABLE TIES**

**42**

**43**

### PERFORM EPS VERIFICATION

1. Turn the ignition off.
2. Remove all test equipment.
3. Connect all previously disconnected components and connectors.
4. Verify all accessories are turned off, the battery is fully charged and the charging system has a status of "charged".
5. Verify that the ignition is on. With the scan tool, record and erase all Diagnostic Trouble Codes (DTCs) from all modules. Start the engine and allow it to run for two minutes and fully operate the system that was indicating the failure.

NOTE: Turn the steering wheel from stop to stop, holding at each stop position for One second.

6. Turn the ignition off and wait five minutes. Turn the ignition on and using the scan tool, read DTCs from all modules.
7. If there are no DTCs present after turning ignition on, road test the vehicle for at least five minutes.
8. Again, with the scan tool read DTCs. If any DTCs are present, refer to the Table of Contents in the applicable section for the Diagnostic procedure and troubleshoot the new or recurring symptom.
9. If there are no DTCs present and the customer's concern can no longer be duplicated, the repair is complete